GROUP 73

SHIFT LINKAGE

Section	Title
A	Shift Linkage Adjustments - All Series

SECTION A

SHIFT LINKAGE ALL SERIES

CONTENTS

Division	Subject	Paragraph
I	TROUBLE DIAGNOSIS: (Not Applicable)	-
II	DESCRIPTION AND OPERATION: (Not Applicable)	-
III	ADJUSTMENTS AND MINOR SERVICE:	
	"350" and "400" Turbo Hydra-Matic Transmission Linkage Adjustment (Console Shift) - 43-44 and 49000 Series	73-1
	"350" and "400" Turbo Hydra-Matic Transmission Linkage Adjustment (Column Shift) - All Series.	73-2
	3-Speed Manual Transmission Linkage Adjustment - 43-44000 Series	73-3
	4-Speed Manual Transmission Linkage Adjustment (Floor Shift) - All G.S. Series	73-4
	3-Speed Manual Transmission Linkage Adjustment 45-46000 Series	73-5
IV	REMOVAL AND INSTALLATION: (Not Applicable)	-
V	OVERHAUL AND MAJOR SERVICE: (Not Applicable)	-
VI	SPECIFICATIONS: (Not Applicable)	-

73-1 350 AND 400 TURBO HYDRA-MATIC TRANSMISSION LINKAGE ADJUSTMENT (Console Shift)
 . 43.44. 49000 SERIES

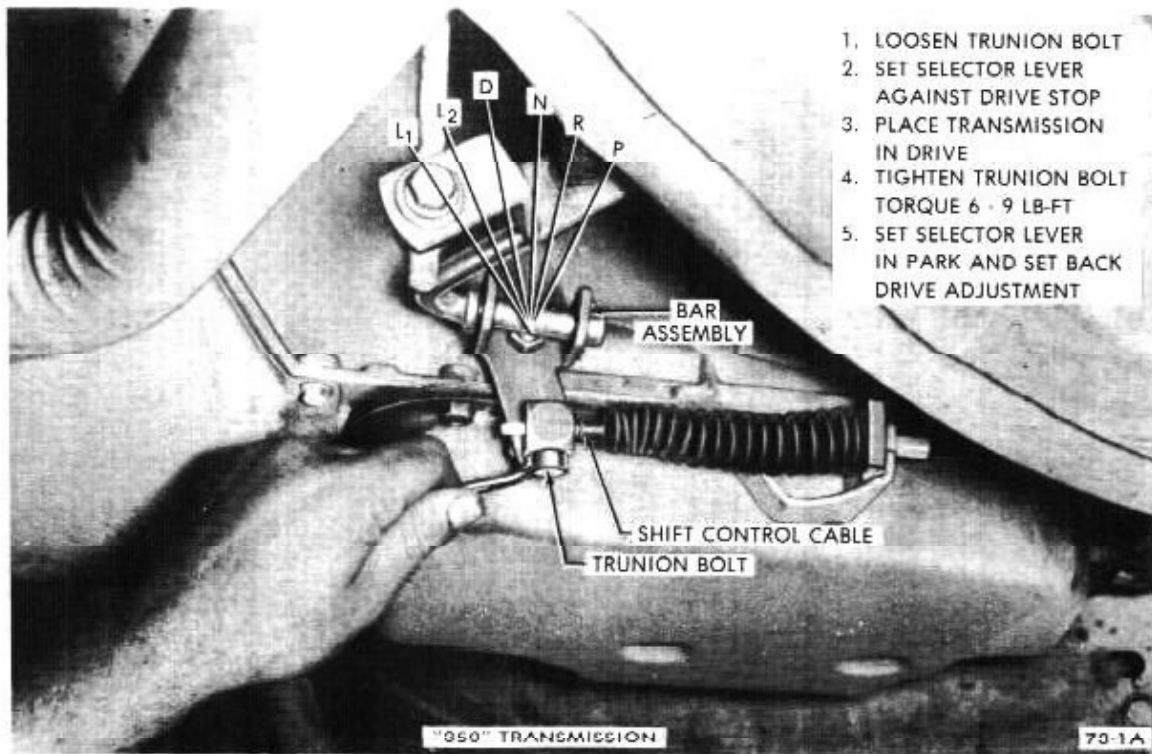

Figure 73-1

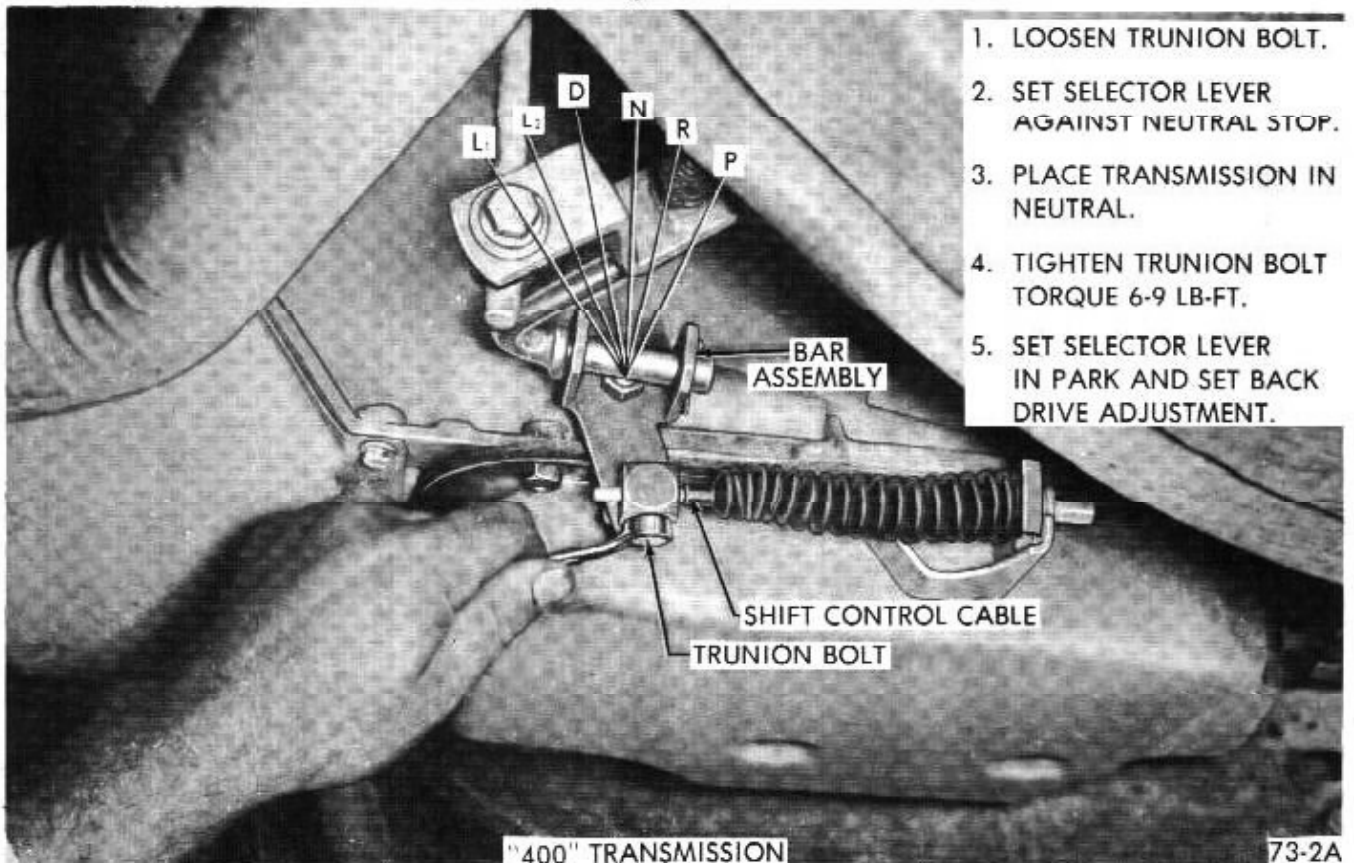

Figure 73-2

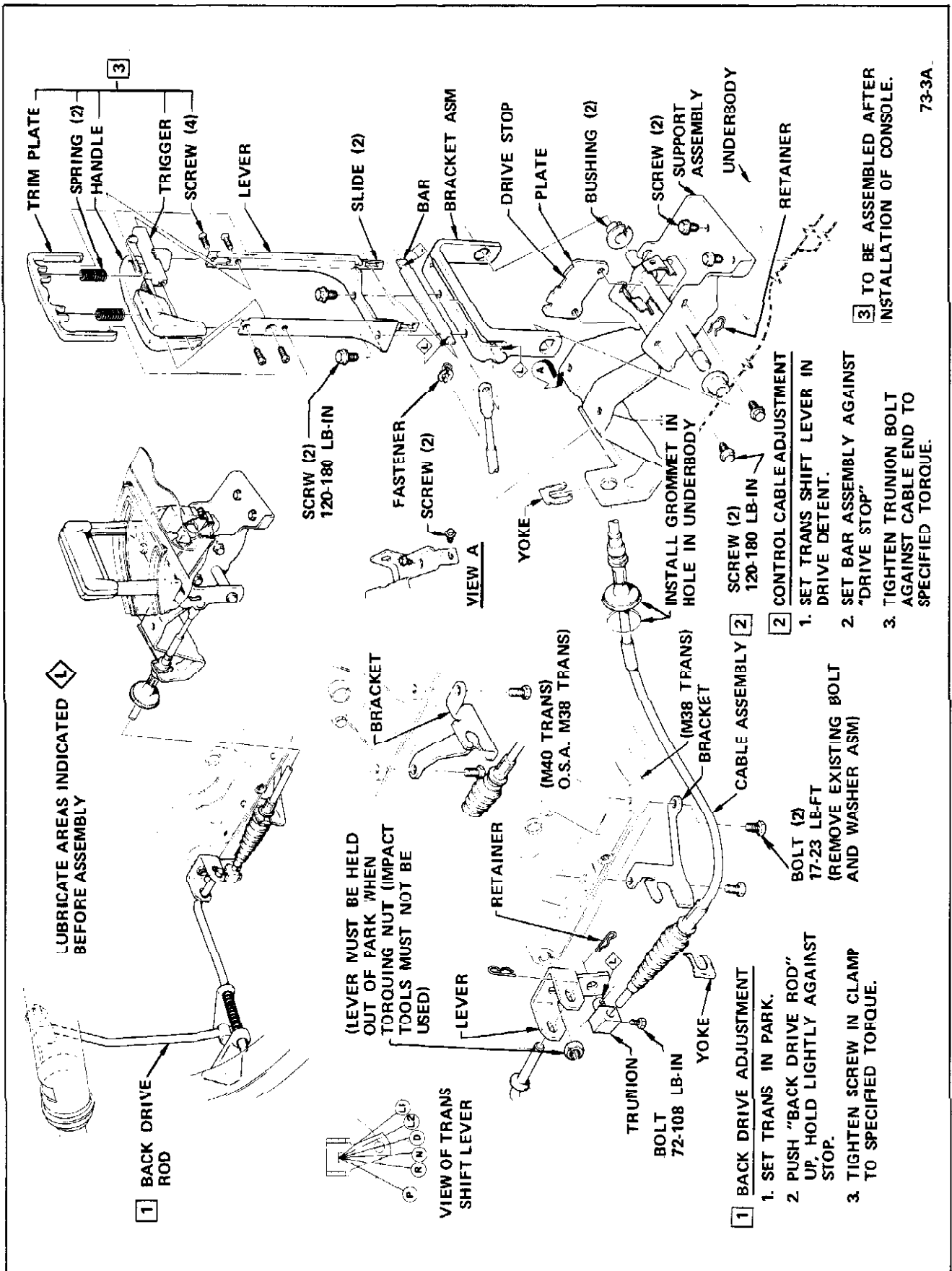

Figure 73-3

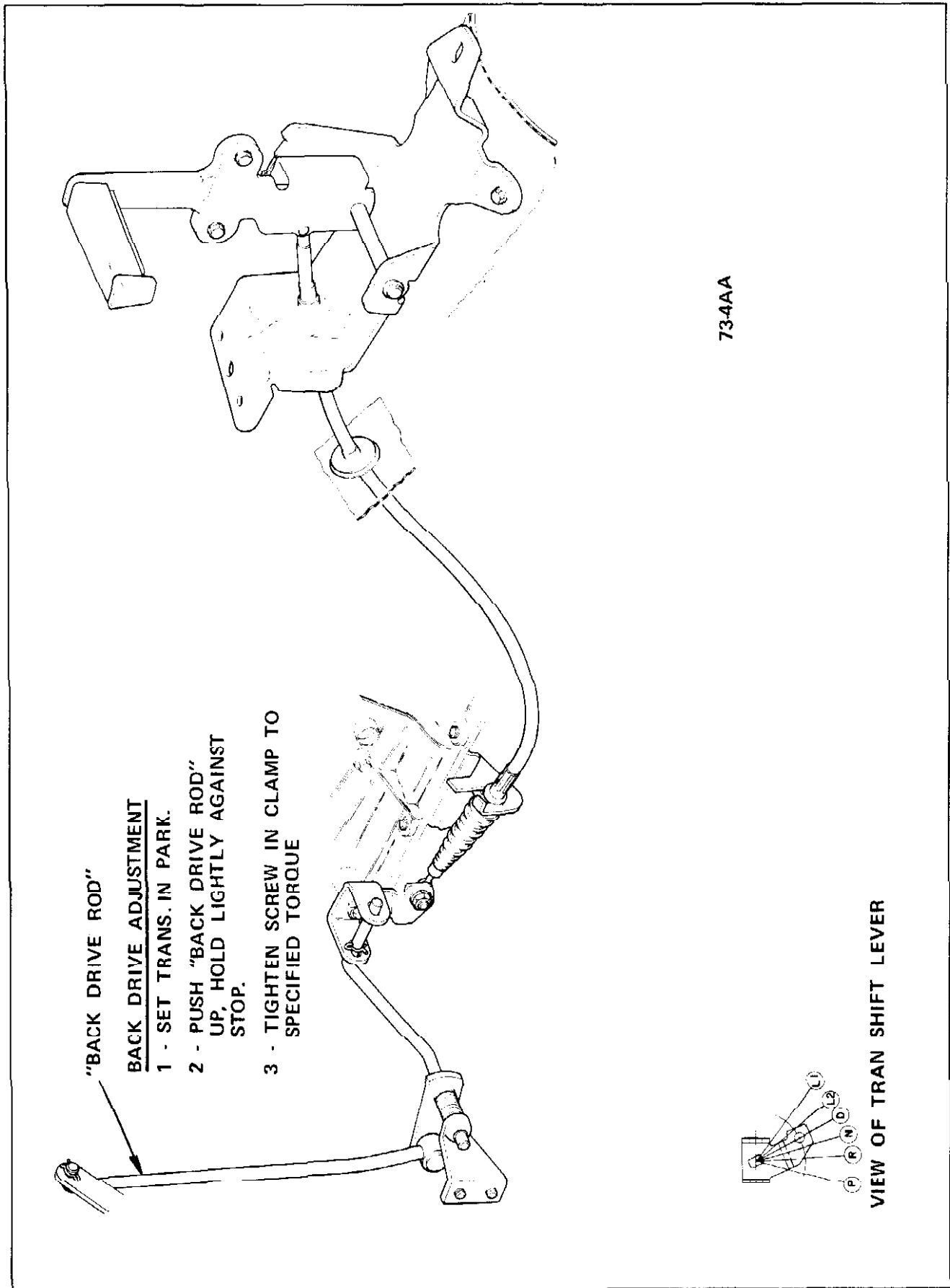
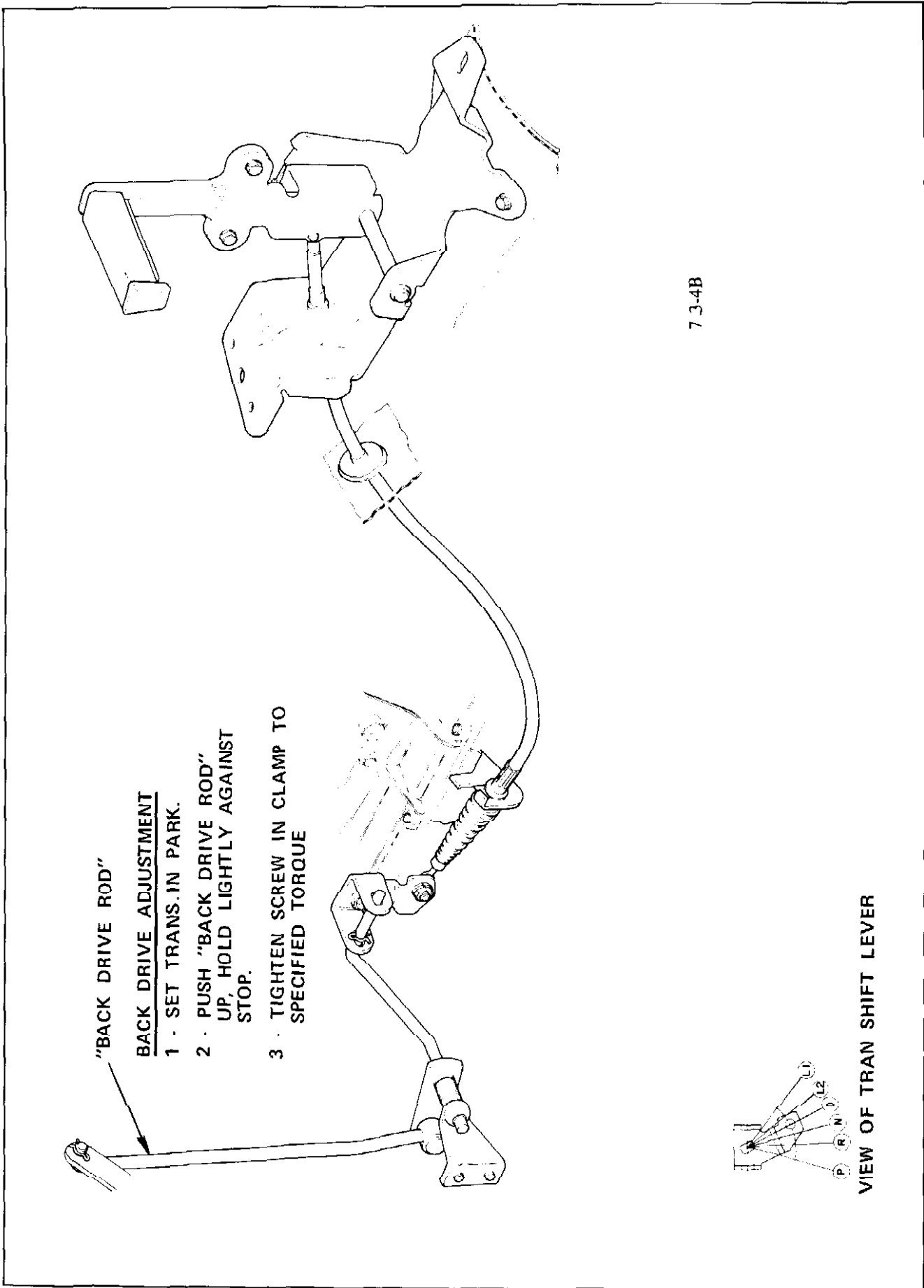

Figure 73-4



7 3-4B

Figure 73-4A

73-2 350 and 400 TURBO HYDRA-MATIC TRANSMISSION LINKAGE ADJUSTMENT (Column Shift) - ALL SERIES

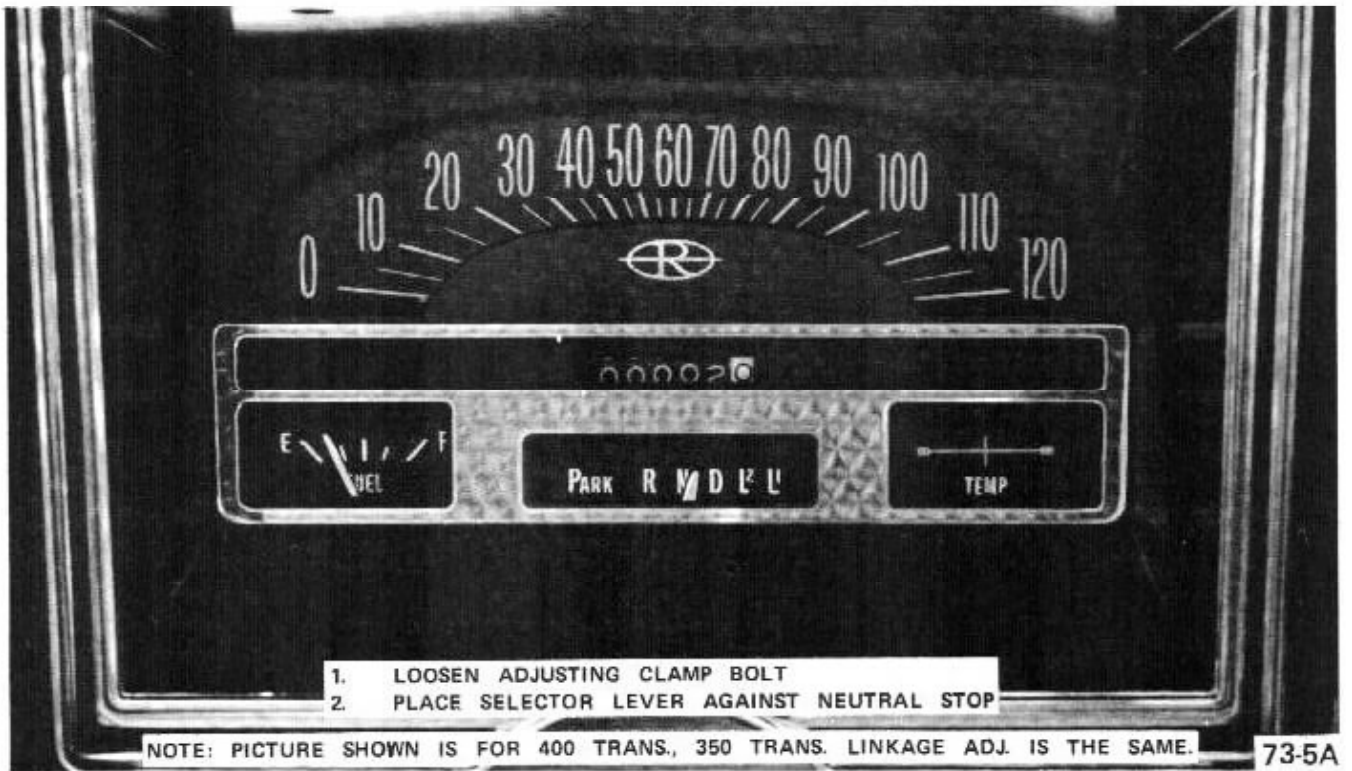

Figure 73-5

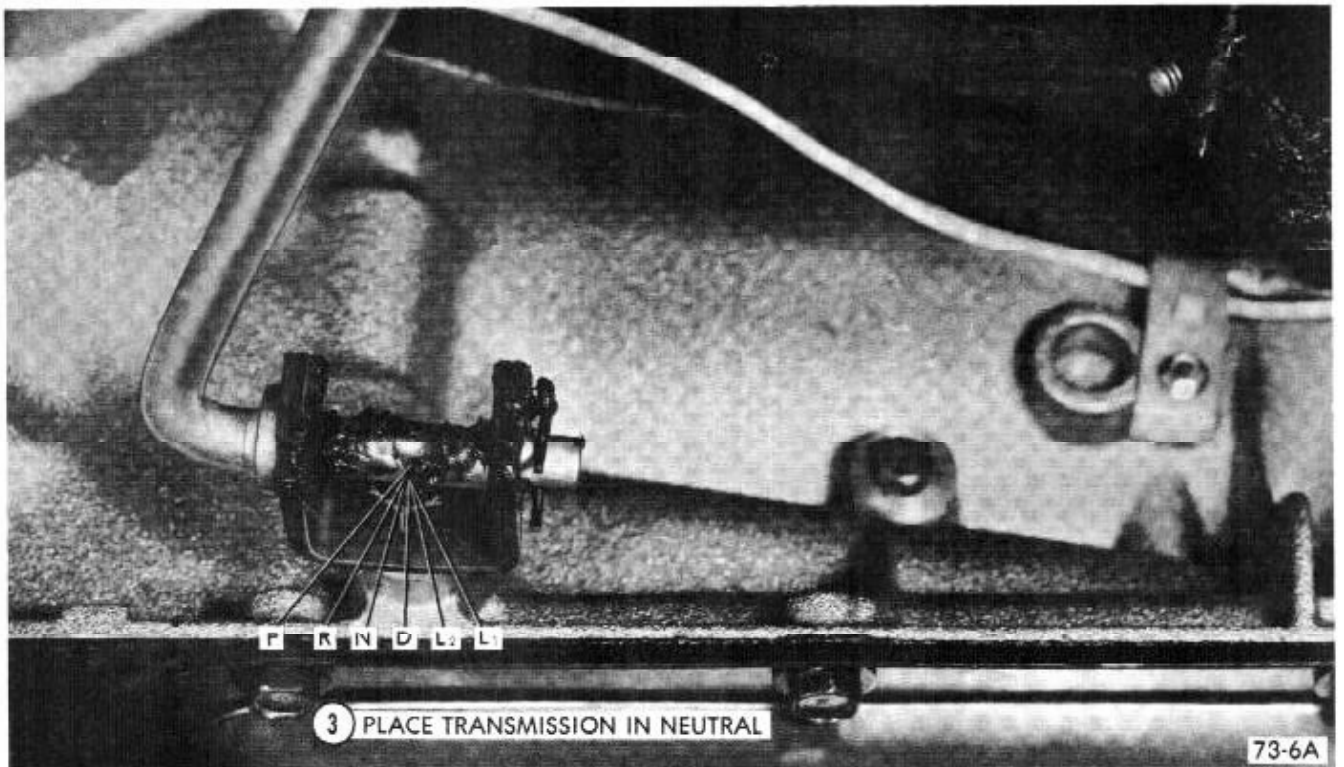

Figure 73-6

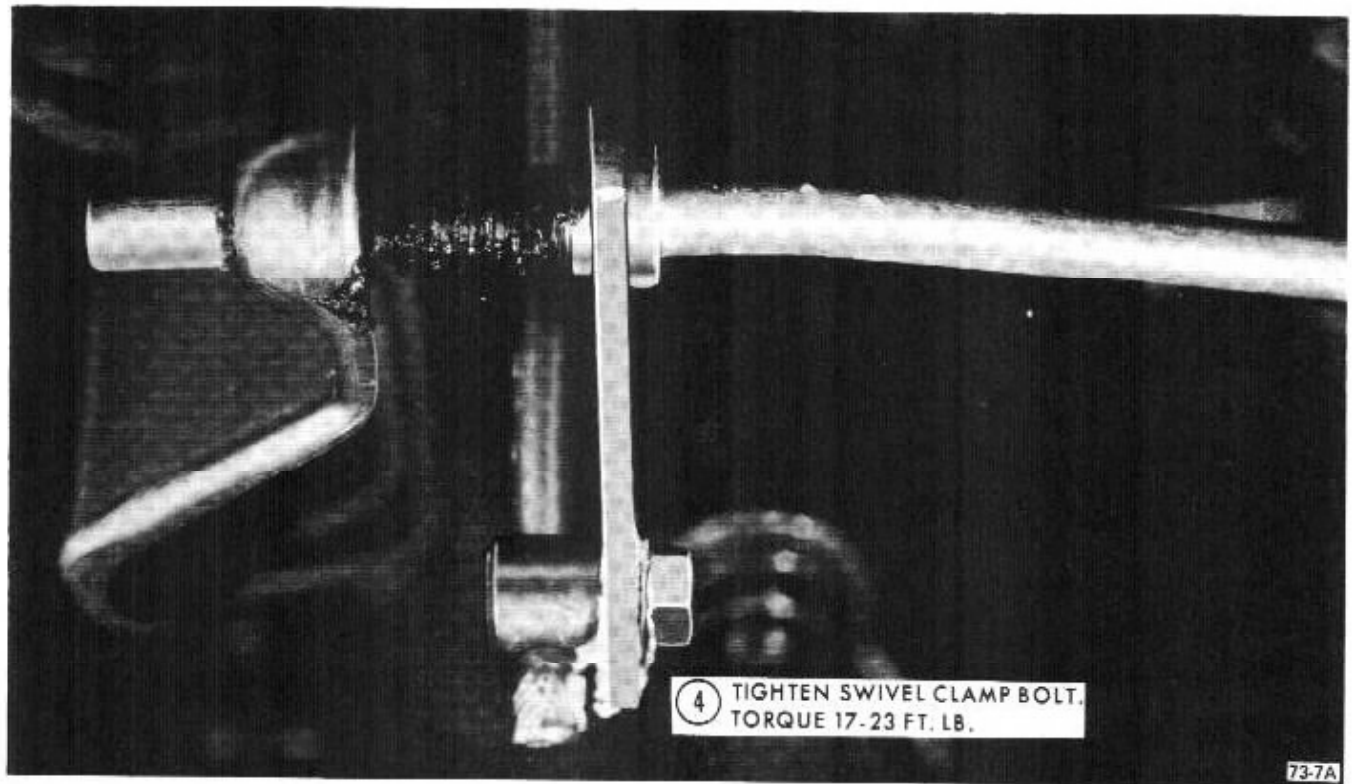

Figure 73-7

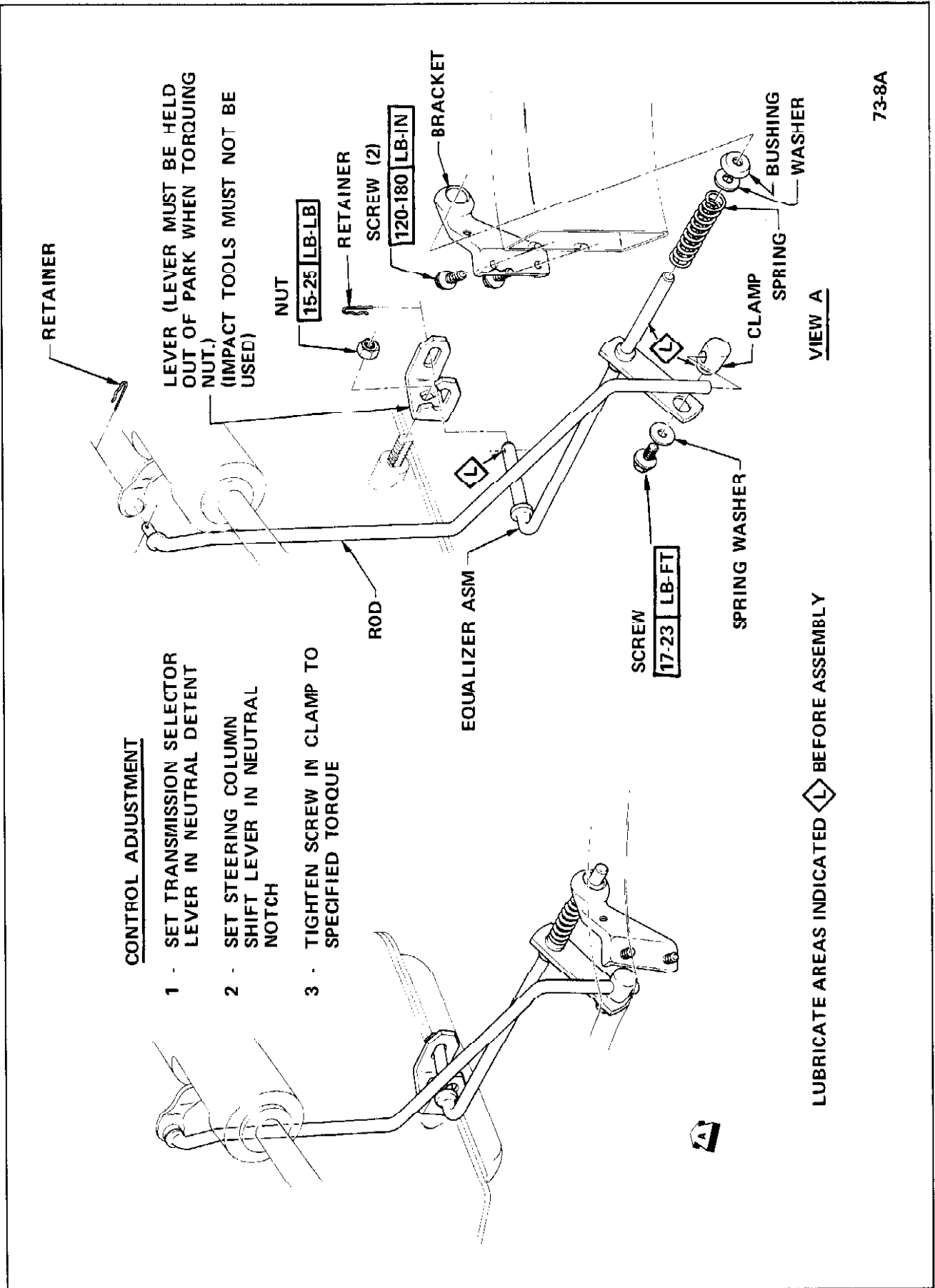
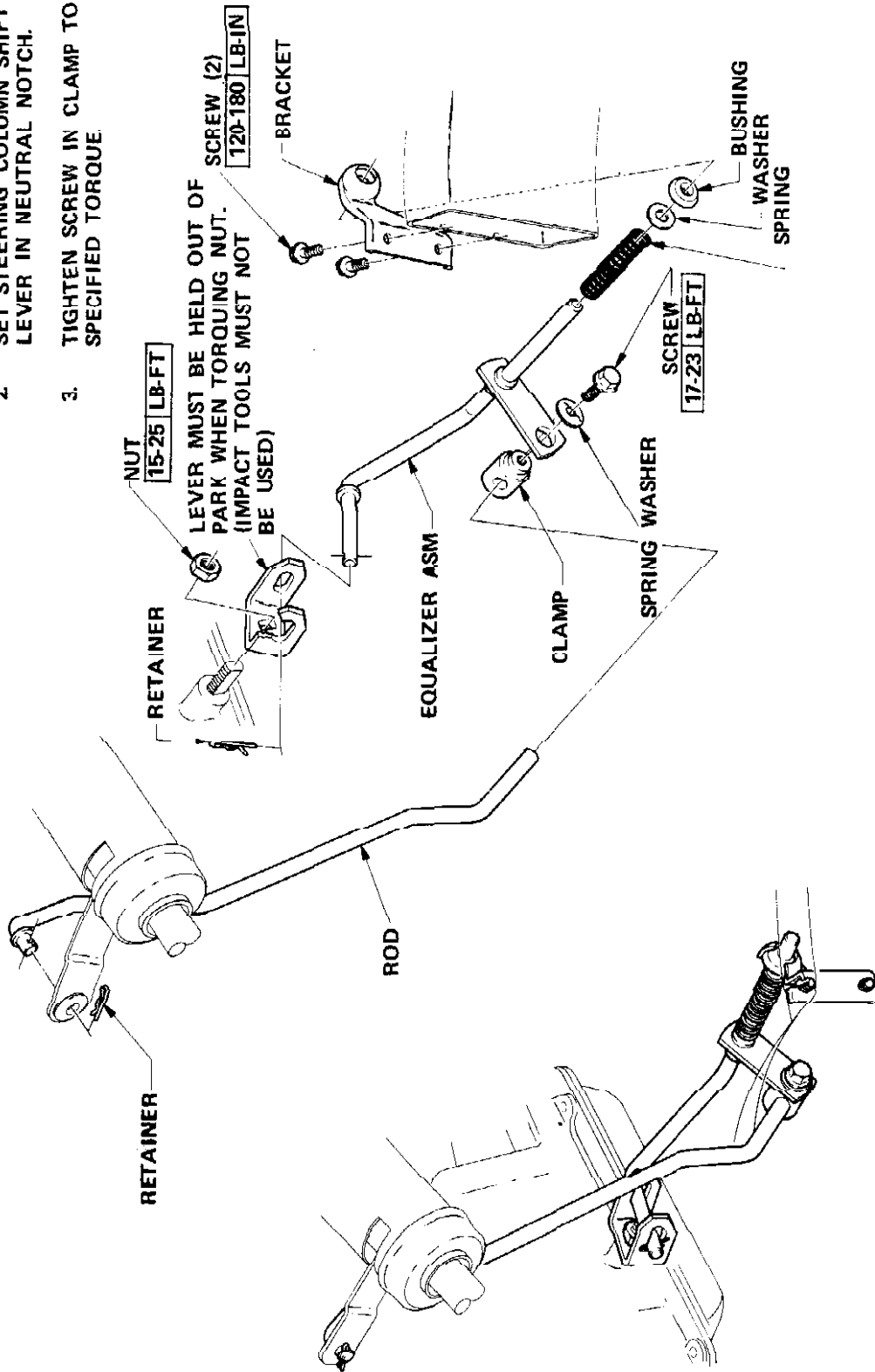

Figure 73-8

CONTROL ADJUSTMENT

1. SET TRANSMISSION SELECTOR LEVER IN NEUTRAL DETENT.
2. SET STEERING COLUMN SHIFT LEVER IN NEUTRAL NOTCH.
3. TIGHTEN SCREW IN CLAMP TO SPECIFIED TORQUE



73-9A

Figure 73-9

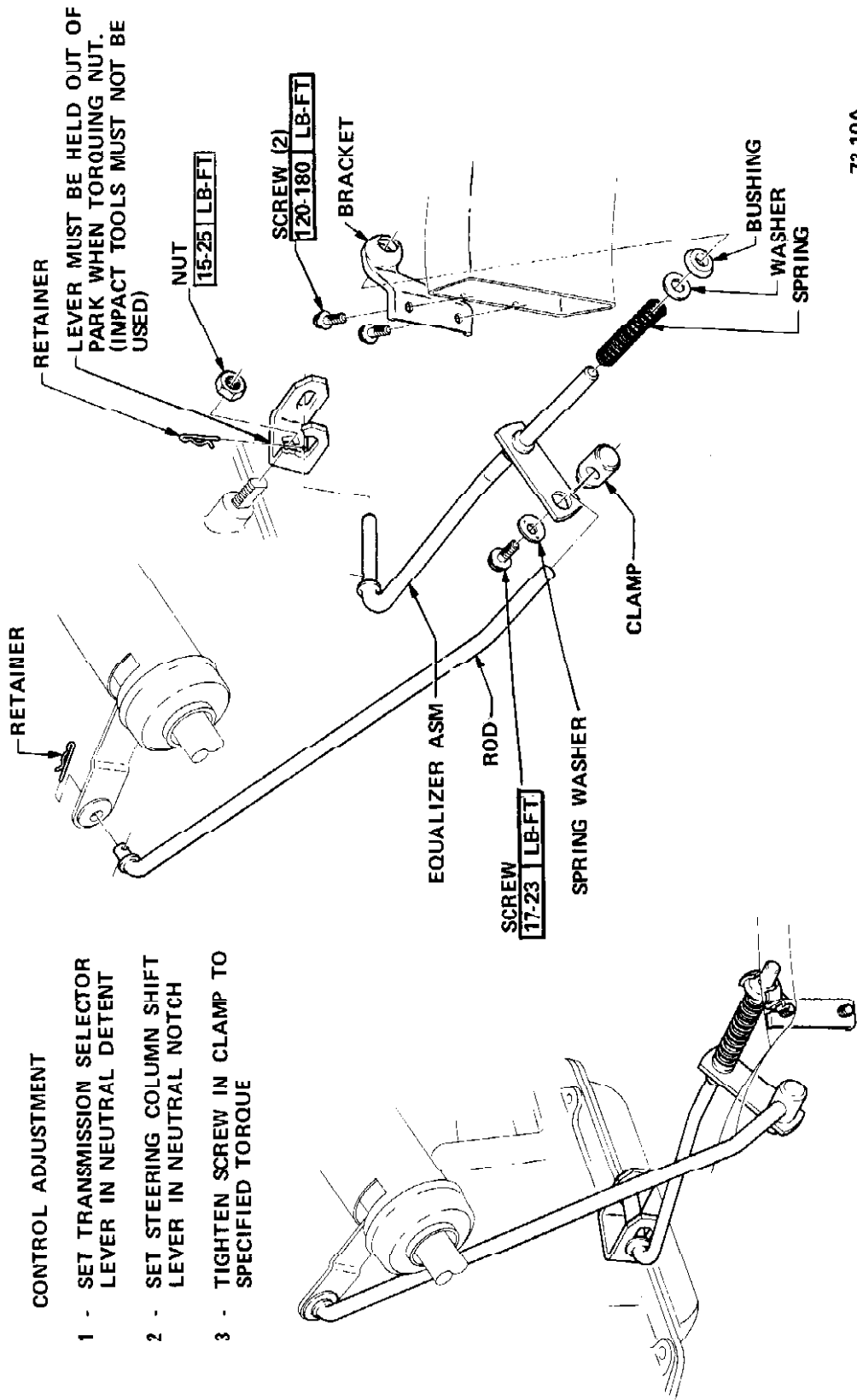

73-10A

Figure 73-10

73-3 3-SPEED MANUAL TRANSMISSION LINKAGE ADJUSTMENT - 43-44000 SERIES

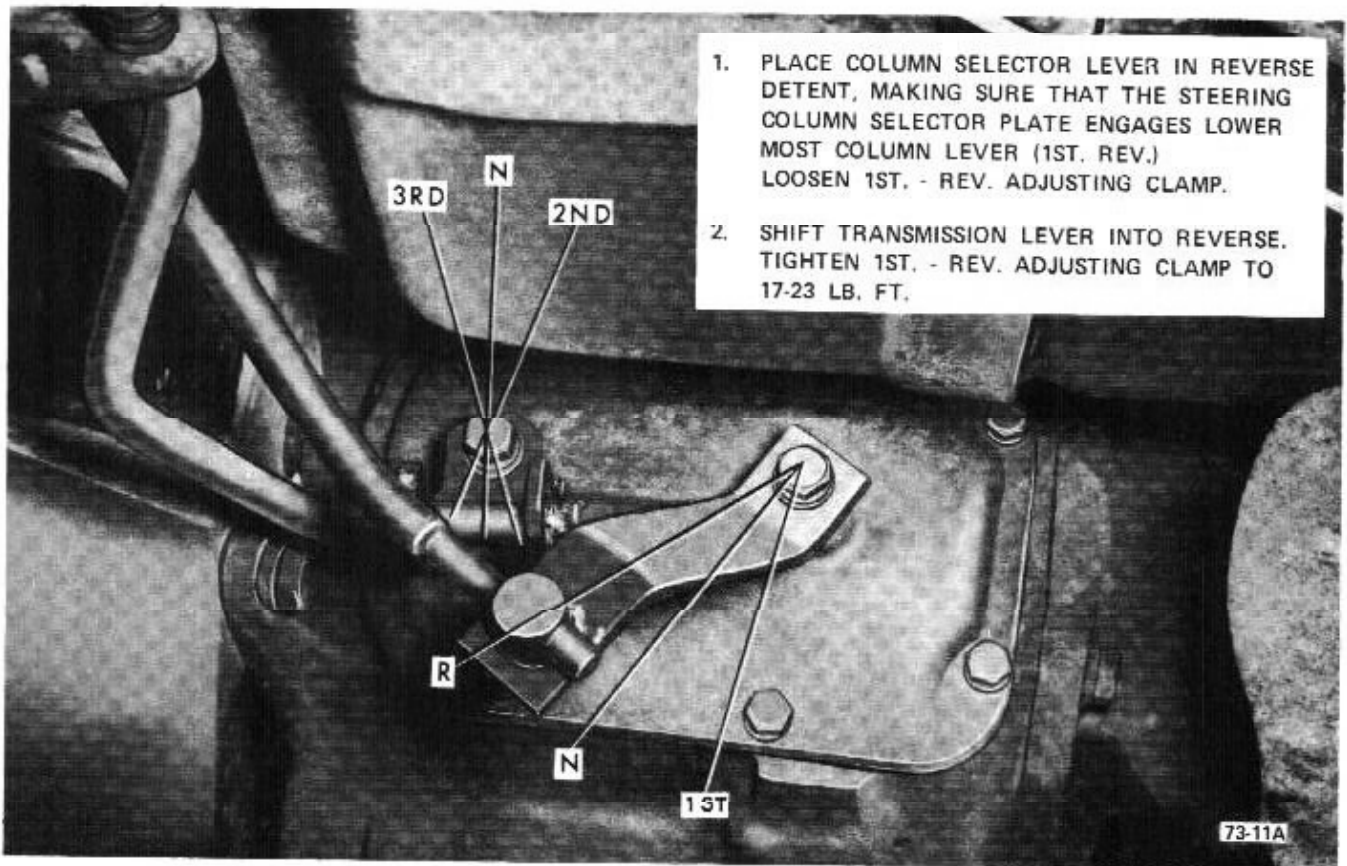

Figure 73-11

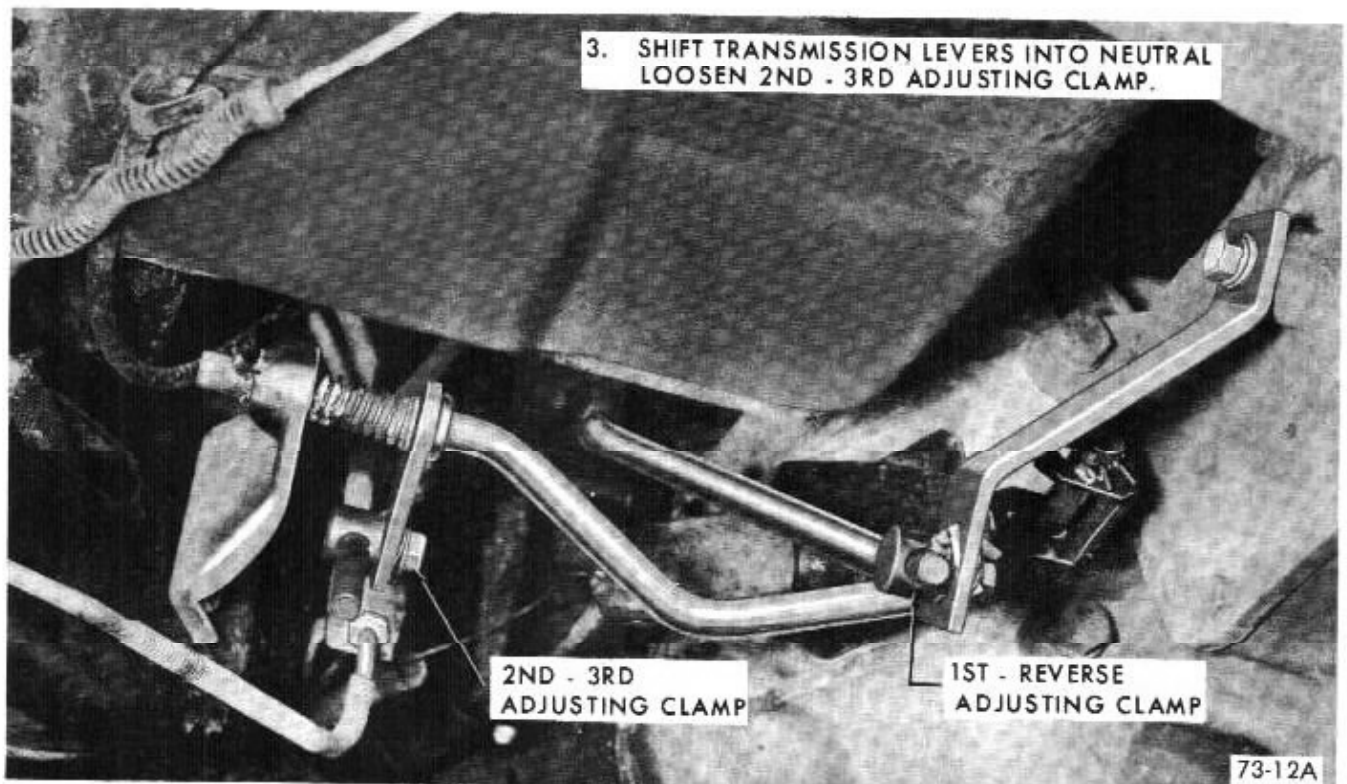
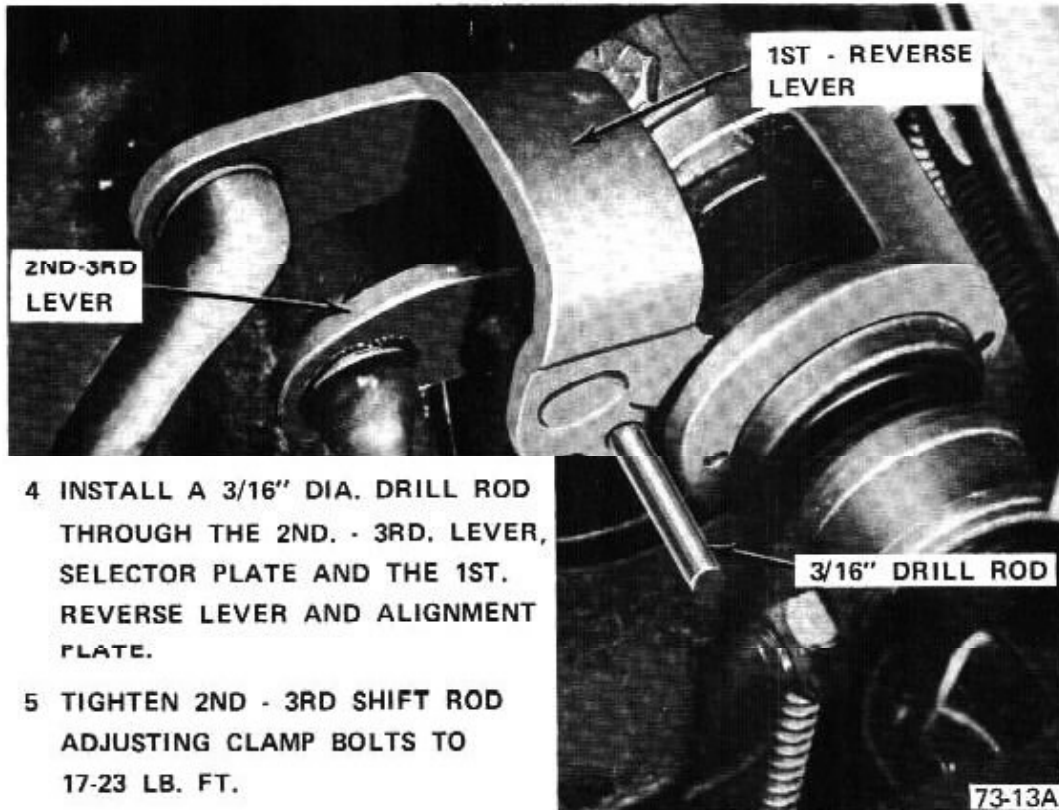
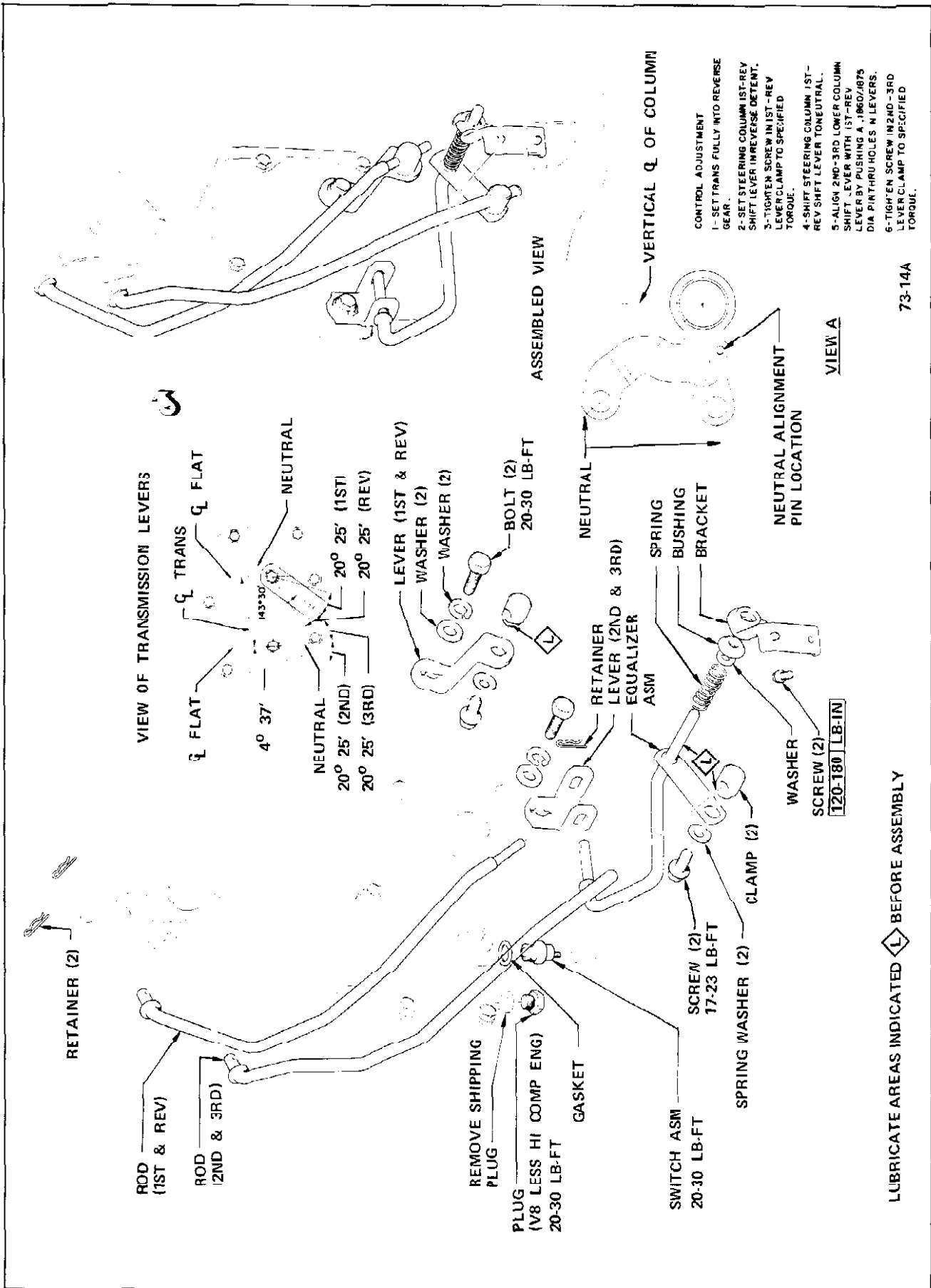

Figure 73-12



- 4 INSTALL A 3/16" DIA. DRILL ROD THROUGH THE 2ND. - 3RD. LEVER, SELECTOR PLATE AND THE 1ST. REVERSE LEVER AND ALIGNMENT PLATE.
- 5 TIGHTEN 2ND - 3RD SHIFT ROD ADJUSTING CLAMP BOLTS TO 17-23 LB. FT.

Figure 73-13



73-14A

Figure 73-14

73-4 4-SPEED MANUAL TRANSMISSION LINKAGE ADJUSTMENT (Floor Shift) - ALL G.S. SERIES

SHIFT LINKAGE ADJUSTMENT
SEE VIEW A

- 1 BACK DRIVE ADJUSTMENT
SEE VIEW A
- 2 BACK DRIVE ADJUSTMENT
SEE VIEW A
- 3 TIGHTEN SCREW IN CLAMP TO SPECIFIED TORQUE.

LUBRICATE AREAS INDICATED  BEFORE ASSEMBLY.

INSERT .250 / .249 DIA ROD WITH ALL TRAN & CONTROL LEVERS IN NEUTRAL POSITION. MAKE SHIFT ROD ADJUSTMENTS AND TIGHTEN NUTS TO SPECIFIED TORQUE.

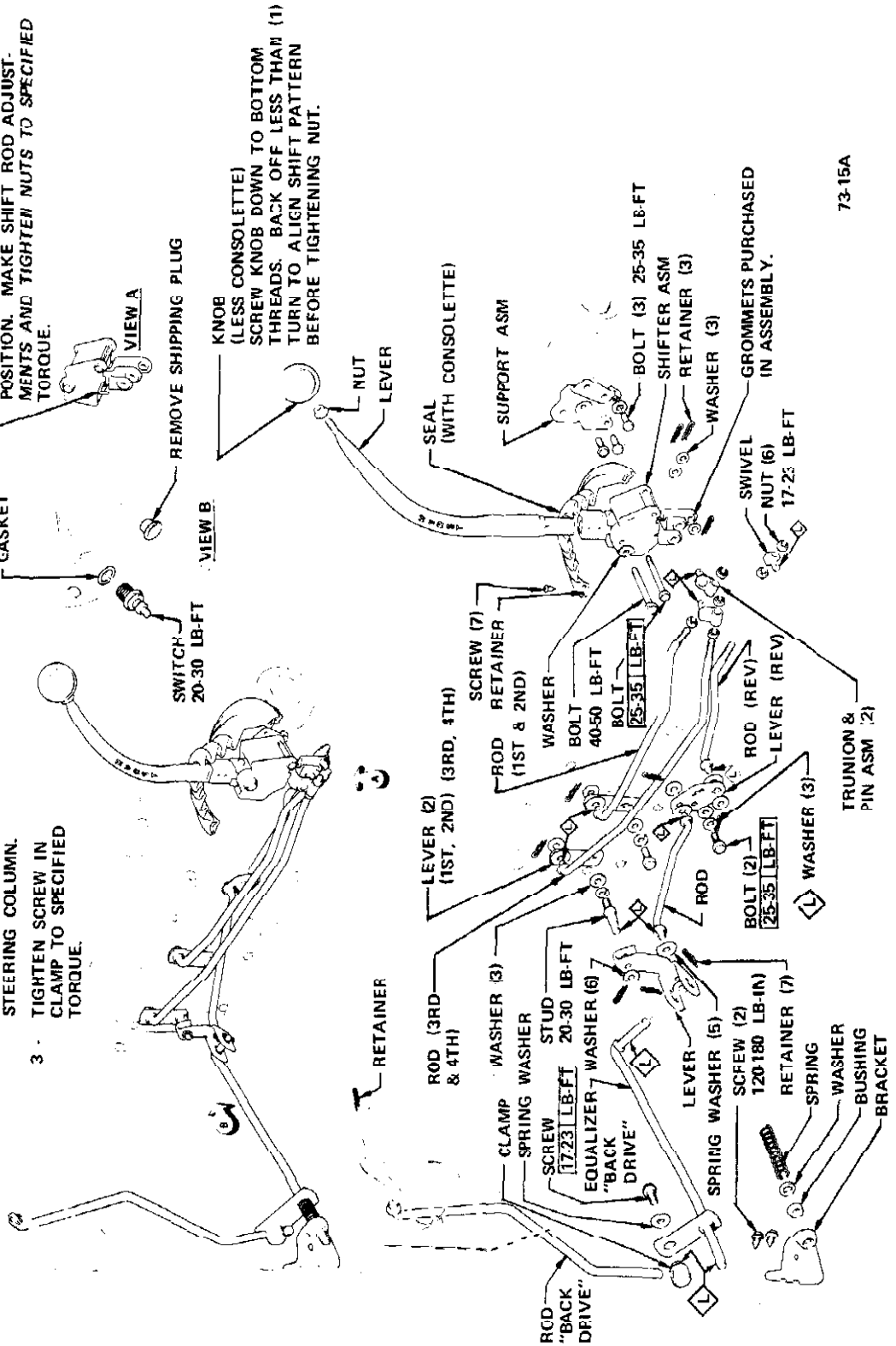

73-15A

Figure 73-15

73-5 3-SPEED MANUAL TRANSMISSION LINKAGE ADJUSTMENT (Column Shift) 45-46-000 SERIES

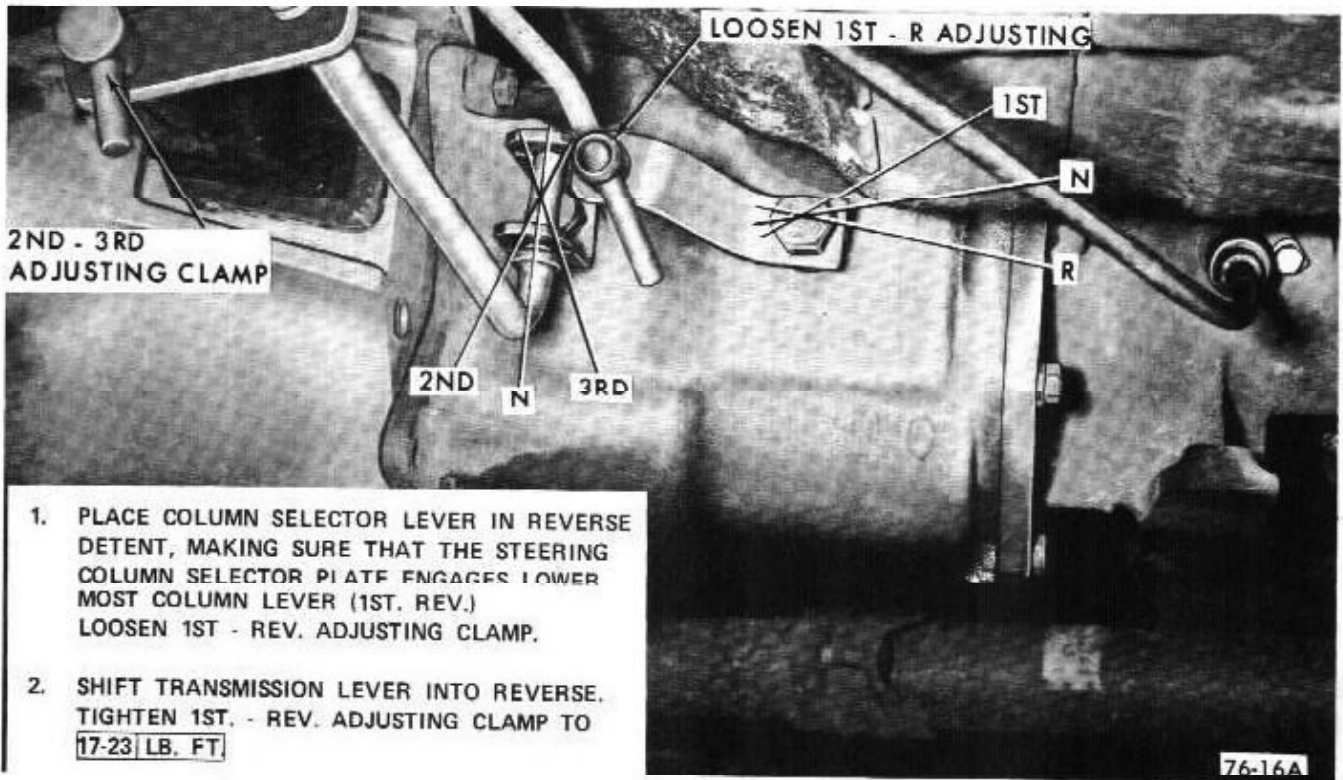

Figure 73-16

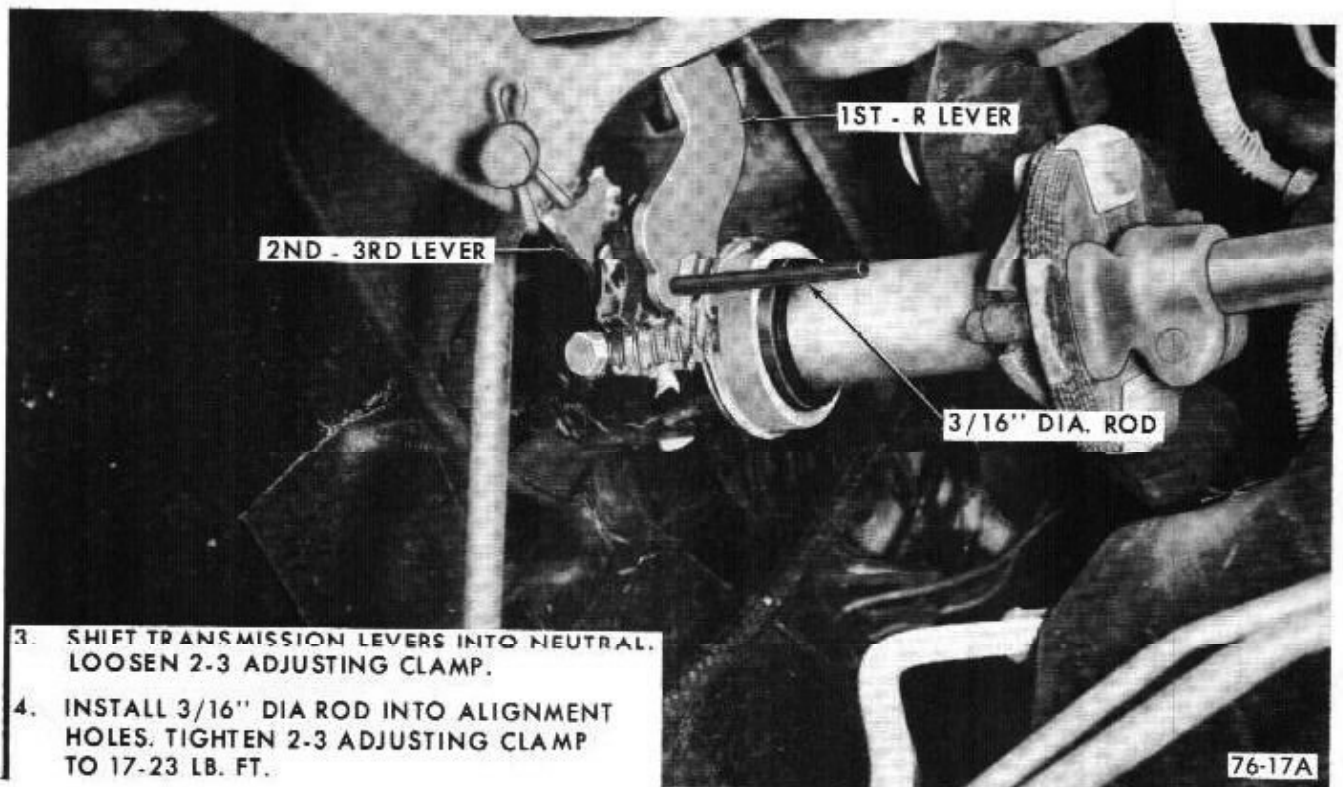

Figure 73-17

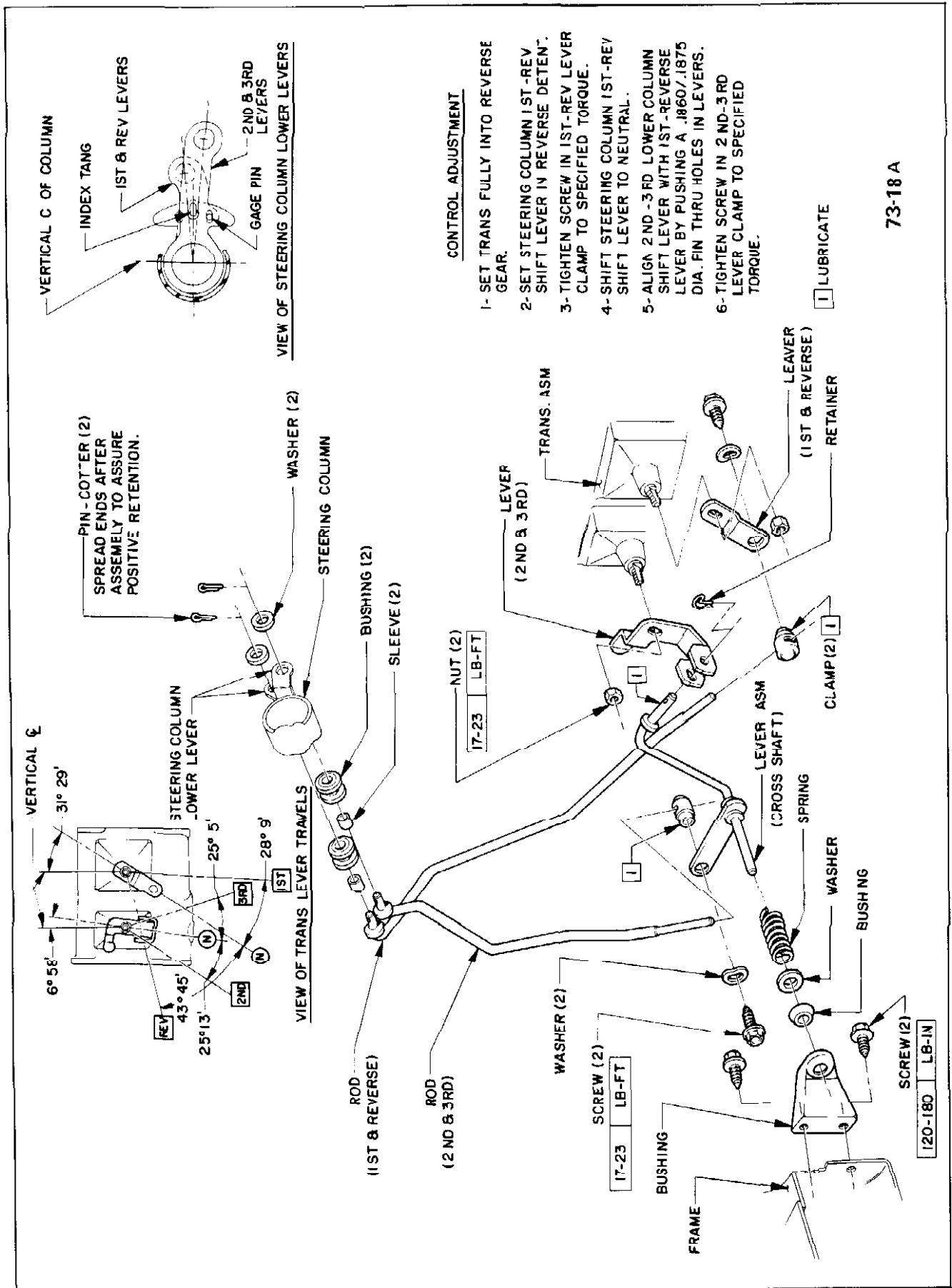

Figure 73-18